

RK45/RK60/RK90 - Architectural Fire Rated Doors

Superior quality fire rated doors manufactured with a full mineral core and mineral stiles/rails.

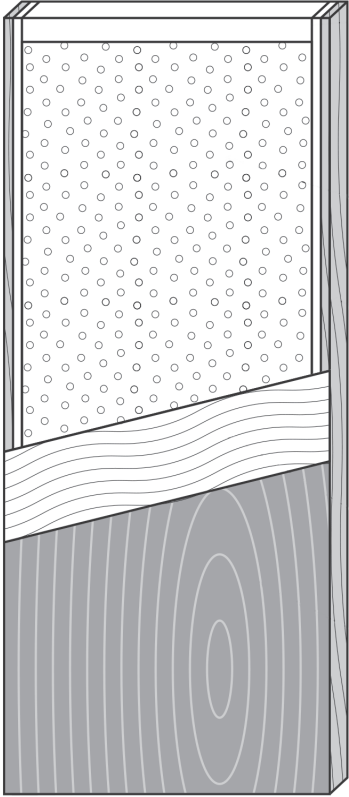

Specifications

Core

Non-combustible composite mineral core with a minimum density of 28 lbs/ft³ (454 kg/m³), and a minimum compressive strength of 250 lb/in² (1724 kPa).

Rails

Non-combustible composite mineral firestop top rail at a minimum width of 5" (127mm) and bottom rail at a minimum width of 1" (25.40mm). Mid rail can be added for internal blocking to allow hardware to be screwed in to the door.

Stiles

Non-combustible composite mineral firestop inner stiles at a minimum width of 1". For RK45 doors less than 36" in width, firestop inner stiles not required.

Edges

Solid wood to match door face, at a minimum width of 7/8" (22.23mm), bonded to inner stile or mineral core (if inner stile is not required).

Crossband

3mm HDF crossbanding, if required.

Faces

HDF, any species of commercially available wood veneer (book/slip/sequence matched, horizontal/vertical grain), or plastic laminate.

Finish

Paint grade, stain grade, clear lacquered, or pre-finished a custom stain.

Additional Options

Fire Rating

45-Minute, 60-Minute, or 90-Minute Warnock Hersey fire door certification. Door stiles and rails will be manufactured to conform to respective Warnock Hersey standards.

Lite Openings

Lite openings for RK45/RK60/RK90 have design restrictions. A metal or veneer-wrapped vision panel is also required (supplied by RK). Please contact your sales representative for more details.

Grooving/Solid Inlays

Not permitted for RK45/RK60/RK90 fire rated doors.

Hardware Preparation

All hardware preparation must be completed by RK. RK45/RK60/RK90 fire rated doors cannot be altered after certification by RK.

Warranty

Three-year limited warranty. For interior use only.

Special Applications

Pair doors require metal or veneer-wrapped astragals (supplied by RK). Please contact your sales representative to discuss your project.